

TURION SOUTH

EXHIBIT B-1 - INITIAL DISTRICTS' BOUNDARY MAP AND LEGAL DESCRIPTIONS

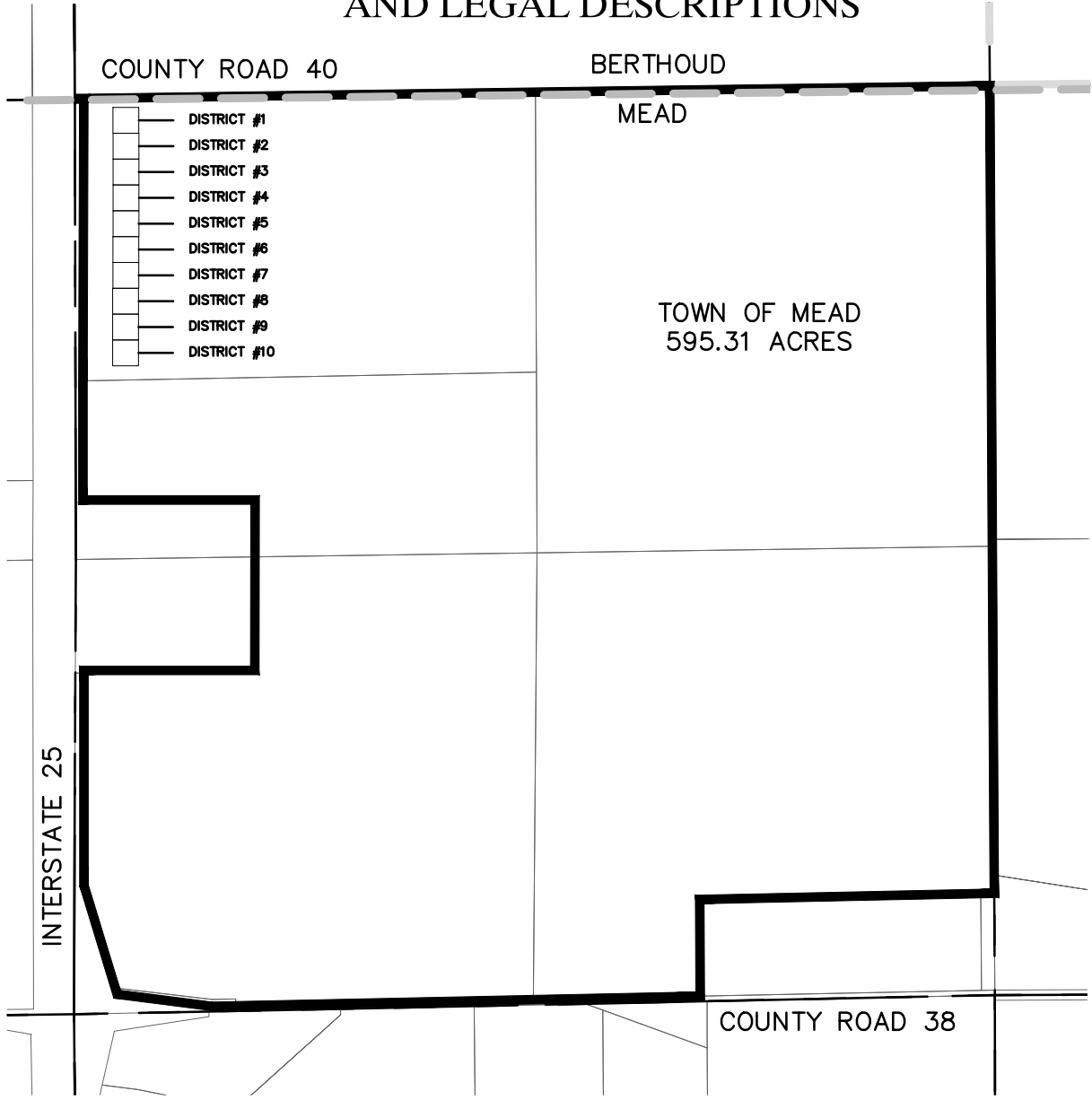

LEGEND	
DISTRICT#	AREA (ACRES)
1	0.52
2	0.52
3	0.52
4	0.52
5	0.52
6	0.52
7	0.52
8	0.52
9	0.52
10	0.52



(IN FEET)
1 inch = 1,000 ft.

PROJECT NO.: 19003715
DATE: 05/06/2022

ATWELL

866.850.4200 www.atwell-group.com

143 UNION BOULEVARD, SUITE 700
LAKEWOOD, CO 80228
303.462.1100

CONTACT: JEFF FRENCH
JFRENCH@ATWELL-GROUP.COM

TURION SOUTH

EXHIBIT B-1 - INITIAL DISTRICTS' BOUNDARY MAP AND LEGAL DESCRIPTIONS

LEGAL DESCRIPTION - TURION PROPERTY - DISTRICT NO. 1-10

A TRACT OF LAND BEING A PORTION OF THE NORTHWEST QUARTER OF SECTION 35, TOWNSHIP 4 NORTH, RANGE 68 WEST OF THE SIXTH PRINCIPAL MERIDIAN, TOWN OF MEAD, COUNTY OF WELD, STATE OF COLORADO, BEING MORE PARTICULARLY DESCRIBED AS FOLLOWS;

DISTRICT NO. 1

BASIS OF BEARINGS: BEARINGS ARE BASED ON THE NORTH LINE OF THE NORTHWEST QUARTER OF SECTION 35, TOWNSHIP 4 NORTH, RANGE 68 WEST OF THE SIXTH PRINCIPAL MERIDIAN, MONUMENTED AT THE WEST END BY A 3.25" ALUMINUM CAP STAMPED "1994 PLS 7242" AND AT THE EAST END BY A 2.5" ALUMINUM CAP STAMPED "2013 PLS 38345". SAID NORTH LINE BEARS NORTH 89°47'02" EAST WITH ALL BEARINGS CONTAINED HEREIN RELATIVE THERETO;

COMMENCING AT THE NORTHWEST CORNER OF SAID SECTION 35;

THENCE SOUTH 81°31'51" EAST 240.07 FEET TO THE **POINT OF BEGINNING**;

THENCE NORTH 90°00'00" EAST 150.00 FEET;

THENCE SOUTH 00°00'00" EAST 150.00 FEET;

THENCE SOUTH 90°00'00" WEST 150.00 FEET;

THENCE NORTH 00°00'00" WEST 150.00 FEET TO THE **POINT OF BEGINNING**;

SAID TRACT OF LAND CONTAINS 22,500 SQUARE FEET, OR 0.52 ACRES, MORE OR LESS.

DISTRICT NO. 2

BASIS OF BEARINGS: BEARINGS ARE BASED ON THE NORTH LINE OF THE NORTHWEST QUARTER OF SECTION 35, TOWNSHIP 4 NORTH, RANGE 68 WEST OF THE SIXTH PRINCIPAL MERIDIAN, MONUMENTED AT THE WEST END BY A 3.25" ALUMINUM CAP STAMPED "1994 PLS 7242" AND AT THE EAST END BY A 2.5" ALUMINUM CAP STAMPED "2013 PLS 38345". SAID NORTH LINE BEARS NORTH 89°47'02" EAST WITH ALL BEARINGS CONTAINED HEREIN RELATIVE THERETO;

COMMENCING AT THE NORTHWEST CORNER OF SAID SECTION 35;

THENCE SOUTH 52°01'28" EAST 301.23 FEET TO THE **POINT OF BEGINNING**;

THENCE NORTH 90°00'00" EAST 150.00 FEET;

THENCE SOUTH 00°00'00" EAST 150.00 FEET;

THENCE SOUTH 90°00'00" WEST 150.00 FEET;

THENCE NORTH 00°00'00" WEST 150.00 FEET TO THE **POINT OF BEGINNING**;

SAID TRACT OF LAND CONTAINS 22,500 SQUARE FEET, OR 0.52 ACRES, MORE OR LESS.

DISTRICT NO. 3

BASIS OF BEARINGS: BEARINGS ARE BASED ON THE NORTH LINE OF THE NORTHWEST QUARTER OF SECTION 35, TOWNSHIP 4 NORTH, RANGE 68 WEST OF THE SIXTH PRINCIPAL MERIDIAN, MONUMENTED AT THE WEST END BY A 3.25" ALUMINUM CAP STAMPED "1994 PLS 7242" AND AT THE EAST END BY A 2.5" ALUMINUM CAP STAMPED "2013 PLS 38345". SAID NORTH LINE BEARS NORTH 89°47'02" EAST WITH ALL BEARINGS CONTAINED HEREIN RELATIVE THERETO;

COMMENCING AT THE NORTHWEST CORNER OF SAID SECTION 35;

THENCE SOUTH 35°18'16" EAST 410.93 FEET TO THE **POINT OF BEGINNING**;

THENCE NORTH 90°00'00" EAST 150.00 FEET;

THENCE SOUTH 00°00'00" EAST 150.00 FEET;

THENCE SOUTH 90°00'00" WEST 150.00 FEET;

THENCE NORTH 00°00'00" WEST 150.00 FEET TO THE **POINT OF BEGINNING**;

SAID TRACT OF LAND CONTAINS 22,500 SQUARE FEET, OR 0.52 ACRES, MORE OR LESS.

DISTRICT NO. 4

BASIS OF BEARINGS: BEARINGS ARE BASED ON THE NORTH LINE OF THE NORTHWEST QUARTER OF SECTION 35, TOWNSHIP 4 NORTH, RANGE 68 WEST OF THE SIXTH PRINCIPAL MERIDIAN, MONUMENTED AT THE WEST END BY A 3.25" ALUMINUM CAP STAMPED "1994 PLS 7242" AND AT THE EAST END BY A 2.5" ALUMINUM CAP STAMPED "2013 PLS 38345". SAID NORTH LINE BEARS NORTH 89°47'02" EAST WITH ALL BEARINGS CONTAINED HEREIN RELATIVE THERETO;

COMMENCING AT THE NORTHWEST CORNER OF SAID SECTION 35;

THENCE SOUTH 26°04'17" EAST 540.36 FEET TO THE **POINT OF BEGINNING**;

THENCE NORTH 90°00'00" EAST 150.00 FEET;

THENCE SOUTH 00°00'00" EAST 150.00 FEET;

THENCE SOUTH 90°00'00" WEST 150.00 FEET;

THENCE NORTH 00°00'00" WEST 150.00 FEET TO THE **POINT OF BEGINNING**;

SAID TRACT OF LAND CONTAINS 22,500 SQUARE FEET, OR 0.52 ACRES, MORE OR LESS.

PROJECT NO.: 19003715



ATWELL

866.850.4200 www.atwell-group.com

143 UNION BOULEVARD, SUITE 700
LAKEWOOD, CO 80228
303.462.1100

CONTACT: JEFF FRENCH
JFRENCH@ATWELL-GROUP.COM

TURION SOUTH

EXHIBIT B-1 - INITIAL DISTRICTS' BOUNDARY MAP AND LEGAL DESCRIPTIONS

LEGAL DESCRIPTION - TURION PROPERTY - DISTRICT NO. 1-10

A TRACT OF LAND BEING A PORTION OF THE NORTHWEST QUARTER OF SECTION 35, TOWNSHIP 4 NORTH, RANGE 68 WEST OF THE SIXTH PRINCIPAL MERIDIAN, TOWN OF MEAD, COUNTY OF WELD, STATE OF COLORADO, BEING MORE PARTICULARLY DESCRIBED AS FOLLOWS;

DISTRICT NO. 5

BASIS OF BEARINGS: BEARINGS ARE BASED ON THE NORTH LINE OF THE NORTHWEST QUARTER OF SECTION 35, TOWNSHIP 4 NORTH, RANGE 68 WEST OF THE SIXTH PRINCIPAL MERIDIAN, MONUMENTED AT THE WEST END BY A 3.25" ALUMINUM CAP STAMPED "1994 PLS 7242" AND AT THE EAST END BY A 2.5" ALUMINUM CAP STAMPED "2013 PLS 38345". SAID NORTH LINE BEARS NORTH 89°47'02" EAST WITH ALL BEARINGS CONTAINED HEREIN RELATIVE THERETO;

COMMENCING AT THE NORTHWEST CORNER OF SAID SECTION 35;

THENCE SOUTH 20°29'42" EAST 678.29 FEET TO THE **POINT OF BEGINNING**;

THENCE NORTH 90°00'00" EAST 150.00 FEET;

THENCE SOUTH 00°00'00" EAST 150.00 FEET;

THENCE SOUTH 90°00'00" WEST 150.00 FEET;

THENCE NORTH 00°00'00" WEST 150.00 FEET TO THE **POINT OF BEGINNING**;

SAID TRACT OF LAND CONTAINS 22,500 SQUARE FEET, OR 0.52 ACRES, MORE OR LESS.

DISTRICT NO. 6

BASIS OF BEARINGS: BEARINGS ARE BASED ON THE NORTH LINE OF THE NORTHWEST QUARTER OF SECTION 35, TOWNSHIP 4 NORTH, RANGE 68 WEST OF THE SIXTH PRINCIPAL MERIDIAN, MONUMENTED AT THE WEST END BY A FOUND 3.25" ALUMINUM CAP STAMPED "1994 PLS 7242" AND AT THE EAST END BY A FOUND 2.5" ALUMINUM CAP STAMPED "2013 PLS 38345". SAID NORTH LINE BEARS NORTH 89°47'02" EAST WITH ALL BEARINGS CONTAINED HEREIN RELATIVE THERETO;

COMMENCING AT THE NORTHWEST CORNER OF SAID SECTION 35;

THENCE SOUTH 16°49'20" EAST 820.49 FEET TO THE **POINT OF BEGINNING**;

THENCE NORTH 90°00'00" EAST 150.00 FEET;

THENCE SOUTH 00°00'00" EAST 150.00 FEET;

THENCE SOUTH 90°00'00" WEST 150.00 FEET;

THENCE NORTH 00°00'00" WEST 150.00 FEET TO THE **POINT OF BEGINNING**;

SAID TRACT OF LAND CONTAINS 22,500 SQUARE FEET, OR 0.52 ACRES, MORE OR LESS.

DISTRICT NO. 7

BASIS OF BEARINGS: BEARINGS ARE BASED ON THE NORTH LINE OF THE NORTHWEST QUARTER OF SECTION 35, TOWNSHIP 4 NORTH, RANGE 68 WEST OF THE SIXTH PRINCIPAL MERIDIAN, MONUMENTED AT THE WEST END BY A FOUND 3.25" ALUMINUM CAP STAMPED "1994 PLS 7242" AND AT THE EAST END BY A FOUND 2.5" ALUMINUM CAP STAMPED "2013 PLS 38345". SAID NORTH LINE BEARS NORTH 89°47'02" EAST WITH ALL BEARINGS CONTAINED HEREIN RELATIVE THERETO;

COMMENCING AT THE NORTHWEST CORNER OF SAID SECTION 35;

THENCE SOUTH 14°14'45" EAST 965.06 FEET TO THE **POINT OF BEGINNING**;

THENCE NORTH 90°00'00" EAST 150.00 FEET;

THENCE SOUTH 00°00'00" EAST 150.00 FEET;

THENCE SOUTH 90°00'00" WEST 150.00 FEET;

THENCE NORTH 00°00'00" WEST 150.00 FEET TO THE **POINT OF BEGINNING**;

SAID TRACT OF LAND CONTAINS 22,500 SQUARE FEET, OR 0.52 ACRES, MORE OR LESS.

DISTRICT NO. 8

BASIS OF BEARINGS: BEARINGS ARE BASED ON THE NORTH LINE OF THE NORTHWEST QUARTER OF SECTION 35, TOWNSHIP 4 NORTH, RANGE 68 WEST OF THE SIXTH PRINCIPAL MERIDIAN, MONUMENTED AT THE WEST END BY A FOUND 3.25" ALUMINUM CAP STAMPED "1994 PLS 7242" AND AT THE EAST END BY A FOUND 2.5" ALUMINUM CAP STAMPED "2013 PLS 38345". SAID NORTH LINE BEARS NORTH 89°47'02" EAST WITH ALL BEARINGS CONTAINED HEREIN RELATIVE THERETO;

COMMENCING AT THE NORTHWEST CORNER OF SAID SECTION 35;

THENCE SOUTH 12°20'32" EAST 1111.03 FEET TO THE **POINT OF BEGINNING**;

THENCE NORTH 90°00'00" EAST 150.00 FEET;

THENCE SOUTH 00°00'00" EAST 150.00 FEET;

THENCE SOUTH 90°00'00" WEST 150.00 FEET;

THENCE NORTH 00°00'00" WEST 150.00 FEET TO THE **POINT OF BEGINNING**;

SAID TRACT OF LAND CONTAINS 22,500 SQUARE FEET, OR 0.52 ACRES, MORE OR LESS.

PROJECT NO.: 19003715



ATWELL

866.850.4200 www.atwell-group.com

143 UNION BOULEVARD, SUITE 700
LAKEWOOD, CO 80228
303.462.1100

CONTACT: JEFF FRENCH
JFRENCH@ATWELL-GROUP.COM

TURION SOUTH

EXHIBIT B-1 - INITIAL DISTRICTS' BOUNDARY MAP AND LEGAL DESCRIPTIONS

LEGAL DESCRIPTION - TURION PROPERTY - DISTRICT NO. 1-10

A TRACT OF LAND BEING A PORTION OF THE NORTHWEST QUARTER OF SECTION 35, TOWNSHIP 4 NORTH, RANGE 68 WEST OF THE SIXTH PRINCIPAL MERIDIAN, TOWN OF MEAD, COUNTY OF WELD, STATE OF COLORADO, BEING MORE PARTICULARLY DESCRIBED AS FOLLOWS;

DISTRICT NO. 9

BASIS OF BEARINGS: BEARINGS ARE BASED ON THE NORTH LINE OF THE NORTHWEST QUARTER OF SECTION 35, TOWNSHIP 4 NORTH, RANGE 68 WEST OF THE SIXTH PRINCIPAL MERIDIAN, MONUMENTED AT THE WEST END BY A FOUND 3.25" ALUMINUM CAP STAMPED "1994 PLS 7242" AND AT THE EAST END BY A FOUND 2.5" ALUMINUM CAP STAMPED "2013 PLS 38345". SAID NORTH LINE BEARS NORTH 89°47'02" EAST WITH ALL BEARINGS CONTAINED HEREIN RELATIVE THERETO;

COMMENCING AT THE NORTHWEST CORNER OF SAID SECTION 35;

THENCE SOUTH 10°52'49" EAST 1257.99 FEET TO THE **POINT OF BEGINNING**;

THENCE NORTH 90°00'00" EAST 150.00 FEET;

THENCE SOUTH 00°00'00" EAST 150.00 FEET;

THENCE SOUTH 90°00'00" WEST 150.00 FEET;

THENCE NORTH 00°00'00" WEST 150.00 FEET TO THE **POINT OF BEGINNING**;

SAID TRACT OF LAND CONTAINS 22,500 SQUARE FEET, OR 0.52 ACRES, MORE OR LESS.

DISTRICT NO. 10

BASIS OF BEARINGS: BEARINGS ARE BASED ON THE NORTH LINE OF THE NORTHWEST QUARTER OF SECTION 35, TOWNSHIP 4 NORTH, RANGE 68 WEST OF THE SIXTH PRINCIPAL MERIDIAN, MONUMENTED AT THE WEST END BY A FOUND 3.25" ALUMINUM CAP STAMPED "1994 PLS 7242" AND AT THE EAST END BY A FOUND 2.5" ALUMINUM CAP STAMPED "2013 PLS 38345". SAID NORTH LINE BEARS NORTH 89°47'02" EAST WITH ALL BEARINGS CONTAINED HEREIN RELATIVE THERETO;

COMMENCING AT THE NORTHWEST CORNER OF SAID SECTION 35;

THENCE SOUTH 09°43'38" EAST 1405.59 FEET TO THE **POINT OF BEGINNING**;

THENCE NORTH 90°00'00" EAST 150.00 FEET;

THENCE SOUTH 00°00'00" EAST 150.00 FEET;

THENCE SOUTH 90°00'00" WEST 150.00 FEET;

THENCE NORTH 00°00'00" WEST 150.00 FEET TO THE **POINT OF BEGINNING**;

SAID TRACT OF LAND CONTAINS 22,500 SQUARE FEET, OR 0.52 ACRES, MORE OR LESS.

PROJECT NO.: 19003715



ATWELL

866.850.4200 www.atwell-group.com

143 UNION BOULEVARD, SUITE 700
LAKEWOOD, CO 80228
303.462.1100

CONTACT: JEFF FRENCH
JFRENCH@ATWELL-GROUP.COM